

Product Information

FIPT3TIMINRG - RotoGen 3 Digit Timer Insert

BS EN 1176 - Designed to British & European Standards

MATERIALS

Panel - Two Colour  High Density Polyethylene (HDPE)

SUPPLY METHOD

Insert - Fully assembled

FEATURES



ROTOGEN - Human powered energy for electronics



TIMER - 10 seconds turning provides 5 minutes of timing



RotoGen 
turn, power, play

ELECTRONICS



Insert can be easily attached to your own panel

DIMENSIONS

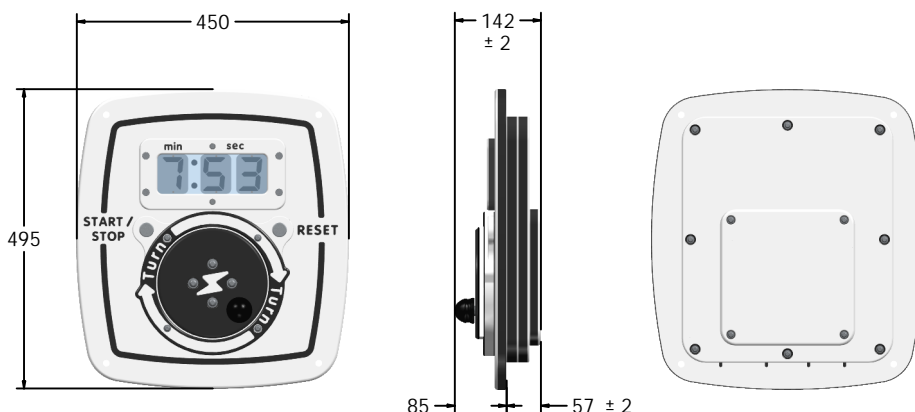

Host Panel Fixing Detail

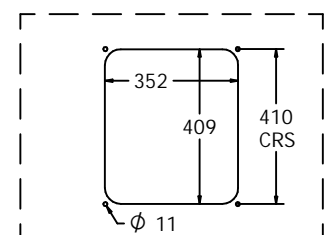

CAD Template Available

TECHNICAL

Age Range: 2+ Years
Largest Part: 450 x 495 x 142mm
Total Weight: 12kg
Surfacing: N/A

IMPORTANT: you must specify the colour option you require at the time of order if it is different from the colour listed/shown above, requirements are subject to availability at the time of order

Fahr Industries Ltd
Spitfire Road, Old Sarum,
Salisbury, Wiltshire, SP4 6GB, UK

© 2025 Fahr Industries Ltd
These designs and content belong to Fahr Industries Ltd and are not to be reproduced in any way or by any means without written permission

Tel: +44 (0)1722 349793
Email: sales@fahr-industries.com
Web: www.fahr-industries.com