

Product Information

FIPTBTIN - PlayTronic Bleep Test Insert

BS EN 1176 - Designed to British & European Standards

MATERIALS

Panel - Two Colour  High Density Polyethylene (HDPE)

SUPPLY METHOD

Insert - Fully assembled

FEATURES

 **BATTERY** - Battery powered PlayTronic synthesizer

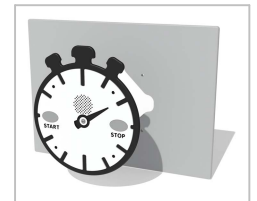
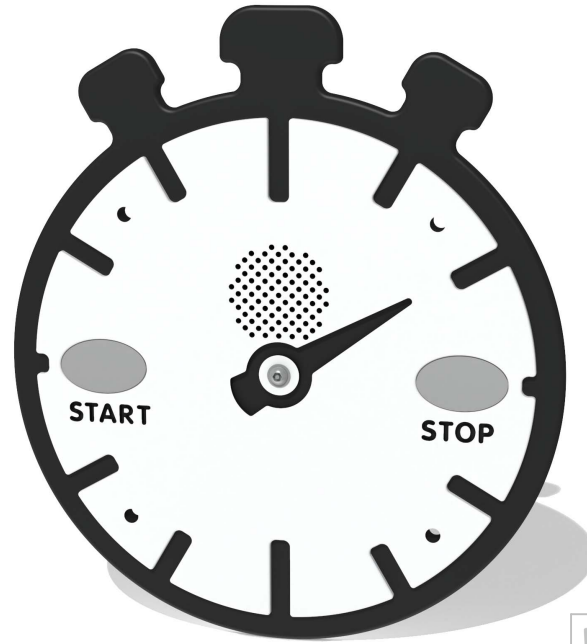

Insert can easily attach to your own panel



PlayTronic
outdoor electronics

ELECTRONICS

DIMENSIONS

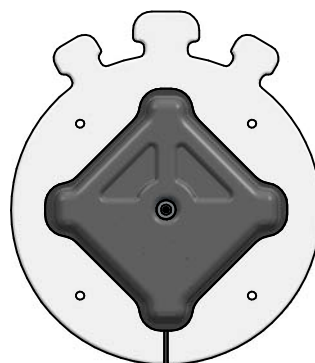
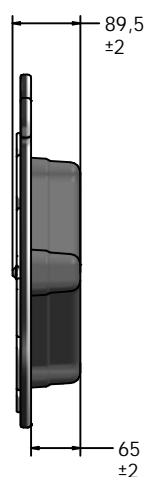
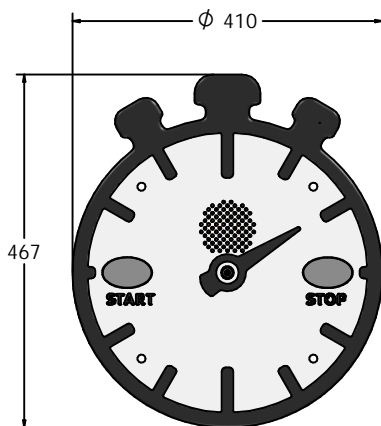

Host Panel Fixing Detail

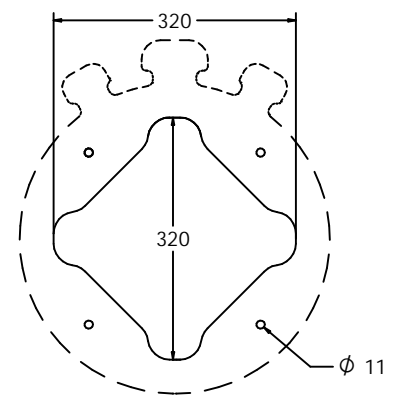

CAD Template Available

TECHNICAL

Age Range: 2+ Years
Largest Part: FIPTBTIN - 410 x 467 x 89.5mm
Total Weight: FIPTBTIN - 3.5kg
Surfacing: N/A

IMPORTANT: you must specify the colour option you require at the time of order if it is different from the colour listed/shown above, requirements are subject to availability at the time of order